

FasCal

Fastest[®]
Your Productivity Connection

CALIBRATE **5 TIMES FASTER!**

- ✓ Transmitters
- ✓ Control Valves
- ✓ Transducers
- ✓ Pressure Gauges
- ✓ Compression Fittings
- ✓ Conduit / Piping

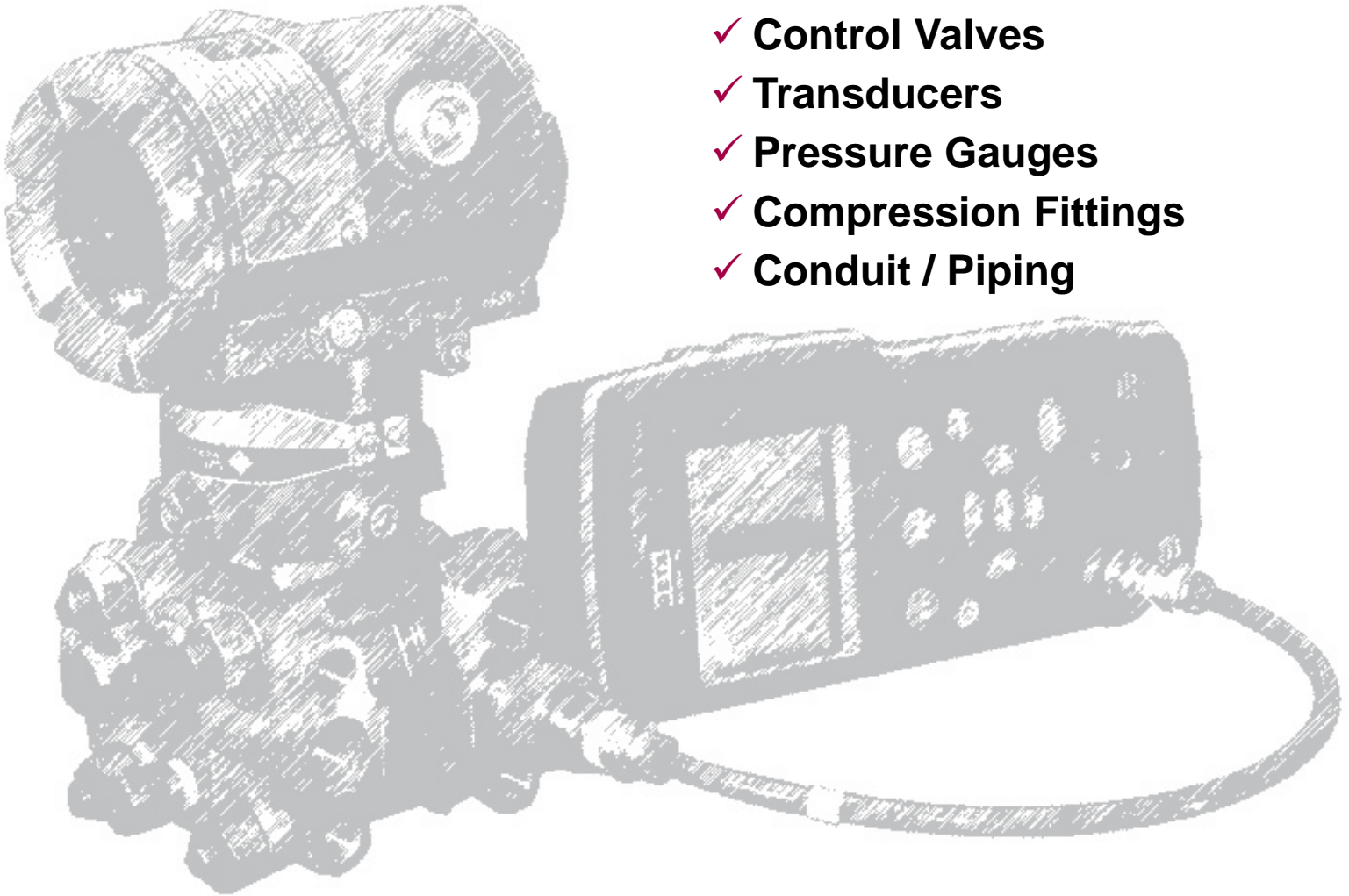

Calibration Connection Devices

No Thread Damage, Wrenches or Pipe Sealant

FasTest's complete line of calibration connection devices feature a patented pressure assisted grip and seal technology that provide leak tight connections, resulting in the highest level of accuracy in the fastest time possible. The ergonomically designed connectors improve productivity, product quality and user comfort. Choose **FasTest** calibration connectors to eliminate sealants, thread damage and wrench tightening, and benefit from an improved calibration process and quality at reduced costs.

Connectors Designed for Calibration!

FasTest's calibration connectivity devices are specifically designed to meet the most frequent challenges or problems facing technicians that calibrate instruments such as transmitters, pressure gauges and transducers.

Calibration technician challenges:

- Calibrate a large quantity of instruments in a short period of time
- Create leak tight connections to a variety of thread profiles
- Eliminate thread damage to instruments
- Minimize contamination to process media



Calibrate Lots of Instruments - Fast!

FasTest's "plug and play" modular connectors eliminate the traditional process of using tape sealant, wrenches and a bit of muscle to create leak tight connections. Comparisons of the FasTest way to traditional methods has shown at least a 5X efficiency improvement.

Connectors for the industries most common:

- Calibrators
- Valve Actuators
- Pressure Gauges
- Transducers
- Compression Fittings
- Pipe Threads



YAMATAKE

Invensys®
FOXBORO

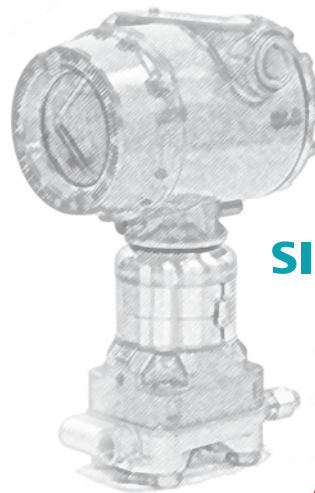

SIEMENS

ABB

smar

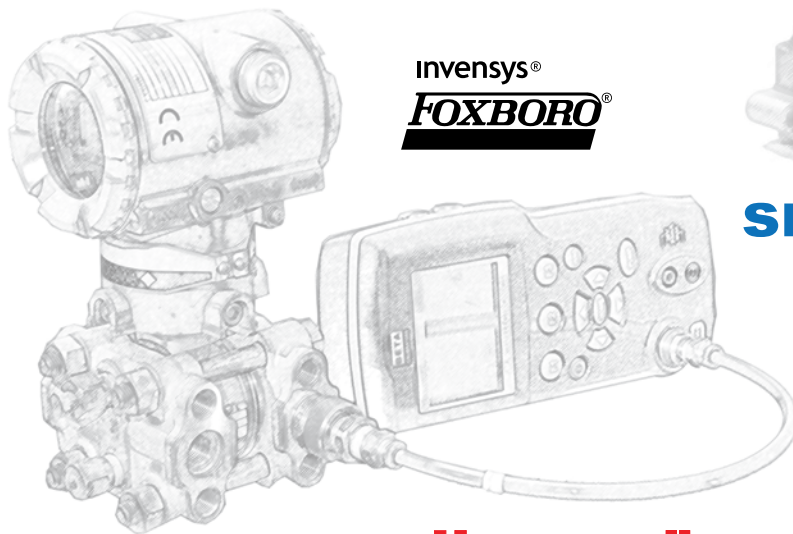

ROSEMOUNT

Honeywell

YOKOGAWA ◆



Connect to a Variety of Profiles - Fast!

Technicians are required to connect to a variety of transmitters, pressure gauges, transducers and other instruments for calibration or maintenance operations. This variety of instruments also comes with a variety of connection sizes as well as internal and external thread profiles.

FasTest transition connectors quickly solve this problem and provide fast connections to popular thread profiles.

- Assembled styles to transition from 1/8" or 1/4" male threads to 1/8", 1/4", 3/8" and 1/2" female threads
- Build your own transitions between the modular **FasCal** connection tools with hose assemblies and fittings



Safe, High Pressure Leak Tight Seals - Fast!

FasTest's patented pressure assisted grip and seal technology delivers repeatable, high pressure and safe leak tight connections. This results in the highest level of accuracy in the fastest time possible.

- Ergonomically designed connection tools improve user comfort
- Pressure rated to 4000, 5000 and 10,000 psi



Eliminate Thread Damage and Contamination

Traditional methods of sealing require a combination of tape sealant, mating thread profiles and torque typically applied with wrenches. Each time a connection is taped and torqued to seal; wear or damage occurs to the mating threads. **FasTest's** grip and seal technology relies on the combination of pressure, seals and patented mechanical design to create leak tight connections.

- Eliminate tape and sealants that can contaminate process media and plug ports
- Minimize thread wear and damage
- Eliminate wrenches and torquing

FasCal - Sleeve Actuated Connectors - HPB Series



FasTest sleeve actuated **HPB** connectors are the preferred method for fast, safe and repeatable connections to *Swagelok*[®], *Ferulok*[®] or similar compression fittings as well as male NPT and “AN” 37° flare style male threads. Simply push on to fitting to connect; pull sleeve away from connection to release.

- Safety feature will not allow disconnect under pressure
- Instant connections to 5000 psi
- No damage to threaded parts during calibration

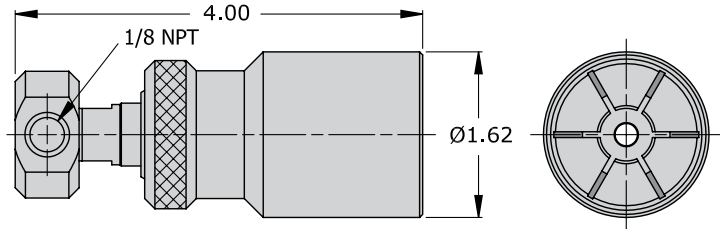

For Compression Fittings

Part Number	Fitting Size	Rating PSI	Housing Material	Seal Material	Main Seals Package (5)
HPB-CF04021	1/4" (7/16-20) Swagelok	5000	Stainless Steel	Buna N	S1008-B70
HPB-CF06021	3/8" (9/16-20) Swagelok	5000			S1011-B70
HPB-CF08021	1/2" (3/4-20) Swagelok	5000			S1013-B70
HPB-CF04021F	1/4" (7/16-20) Ferulok	5000			S1008-B70
HPB-CF06021F	3/8" (9/16-18) Ferulok	5000			S1011-B70
HPB-CF08021F	1/2" (3/4-16) Ferulok	5000			S1013-B70

For NPT Male Threads

Part Number	Thread Size	Rating PSI	Housing Material	Seal Material	Main Seals Package (5)
HPB-041021	1/4" NPT	5000	Stainless Steel	Buna N	S1008-B70
HPB-061021	3/8" NPT	5000			S1011-B70
HPB-081021	1/2" NPT	5000			S1013-B70

For “AN” 37° Flare Male Threads

Part Number	Thread Size	Rating PSI	Housing Material	Seal Material	Main Seals Package (5)
HPB-049021	- 4 (7/16-20)	5000	Stainless Steel	Buna N	S2070-0270B70
HPB-069021	- 6 (9/16-18)	5000			S1012-B70
HPB-089021	- 8 (3/4-16)	5000			S1015-B70

Notes:

Optional seal materials available are FKM (Viton) and EPDM.

Examples: HPB-xxx021**V** = FKM
 HPB-xxx021**E** = EPDM

FasCal - Sleeve Actuated Connectors - 60 Series



Fastest sleeve actuated **60 Series** connectors are ideal fast, safe and repeatable connections to a wide variety of thread used in process and manufacturing industries for filling, pressure and leak testing, and instrument calibration. Simply pull back on the latching sleeve, insert male threaded end into the connector and push the latching sleeve forward to complete the connection. Remove test pressure and pull back the latching sleeve to release the connection.

- Instant connections from vacuum to 750 psi
- Connect to 1/4" and 1/2" NPT, SAE 37° Flare "AN" and compression fittings
- No wrenches, sealants or thread damage
- Rugged stainless steel housing

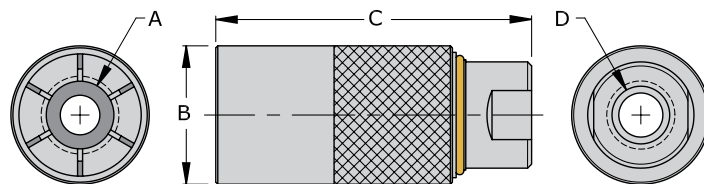

For Double Ferrule Compression Style Fittings - Swagelok®

Part Number	Connects to Dim "A"	Diameter Dim "B"	Length Dim "C"	Term. Thread Dim "D"	Rating PSI	Housing Material	Seal Material	Main Seals Package (5)
60G-CF04	-4 (7/16-20)	0.99"	2.95"	1/8" NPT	750	Stainless Steel	Buna N	S1008-B70

For NPT Pipe Threads

Part Number	Connects to Dim "A"	Diameter Dim "B"	Length Dim "C"	Term. Thread Dim "D"	Rating PSI	Housing Material	Seal Material	Main Seals Package (5)
60G-1T02	1/8" NPT	0.99"	2.95"	1/8" NPT	750	Stainless Steel	Buna N	S1105-B70
60G-1T04021	1/4" NPT	1.19"	2.95"	1/8" NPT				S1109-B70
60G-1T08021	1/2" NPT	1.58"	3.15"	1/8" NPT				S1112-B70

For "AN" 37° Flare Male Threads

Part Number	Connects to Dim "A"	Diameter Dim "B"	Length Dim "C"	Term. Thread Dim "D"	Rating PSI	Housing Material	Seal Material	Main Seals Package (5)
60G-049	-4 (7/16-20)	0.99"	2.95"	1/8" NPT	750	Stainless Steel	Buna N	S1010-B70
60G-069	-6 (9/16-18)	1.38"	3.15"	3/8" NPT				S1012-B70
60G-089	-8 (3/4-16)	1.38"	3.15"	3/8" NPT				S1014-B70

Notes:

Additional sizes available for 60 Series connectors. Consult factory for details.

Optional seal materials available are FKM (Viton) and EPDM.

Examples: 60G-xxxV = FKM
60G-xxxE = EPDM

FasCal - Lever Actuated for 1/4" IEC Transmitter Ports and 1/4" NPT



FasTest lever actuated connectors are an ideal method for fast, safe and repeatable connections to all types of transmitters. Simply squeeze the lever and insert into 1/4" threaded port; release lever for an instant leak tight and high pressure connection.

- Compatible to 1/4" NPT and 1/4" (IEC 61518) 2.126 (54) process flange ports
- Instant connections to 5000 psi eliminates tape, sealants and wrenches
- No damage to threaded parts

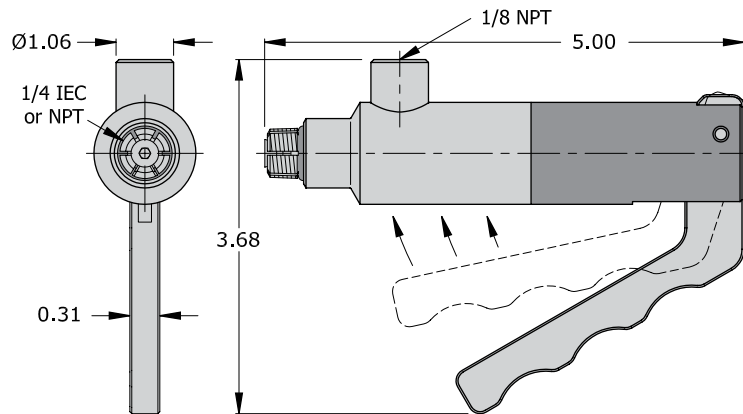

Part Number	Thread Size	Rating PSI	Housing Material	Seal Material	Main Seals Package (5)
L042021TM	1/4" NPT	5000	Stainless Steel	Buna N	SL042-B

Notes:

Optional seal materials available are FKM (Viton) and EPDM.

Examples: L042021TMV = FKM

L042021TME = EPDM

FasCal - "Twist to Connect" Connectors for 1/4" IEC Transmitter Ports



TwistMates unique "twist to connect" and pressure assisted grip and seal delivers fast, safe and repeatable connections. The connector's internal swivel also allows easy installation while plumbed (connected) to a supply line. Simply twist the connector to finger tight for an instant leak tight and high pressure connection.

- Compatible to 1/4" (IEC 61518) 2.126 (54) process flange ports
- Instant connections to 5000 psi eliminates tape, sealants and wrenches
- No damage to threaded parts

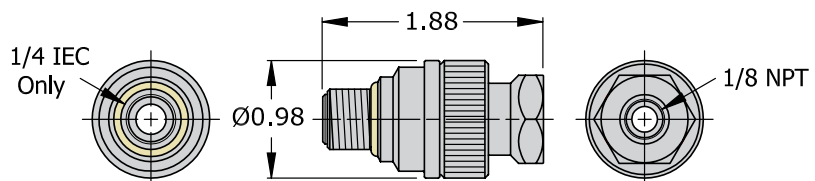

Part Number	Thread Size	Rating PSI	Housing Style	Housing Material	Seal Material	Main Seals Package (5)
MIT-042021TM	1/4" IEC	5000	Swivel	Stainless Steel	Urethane	S1111-U70

Notes:

Optional seal materials available are FKM (Viton) and EPDM.

Examples: MIT-042021TMV = FKM

MIT-042021TME = EPDM

FasCal - "Twist to Connect" Connectors for Female Threads



TwistMates unique "twist to connect" and pressure assisted grip and seal delivers fast, safe and repeatable threaded connections. Simply twist the connector to finger tight for an instant leak tight and high pressure connection.

- Compatible to NPT, BSPP, BSPT and SAE threads
- Plug versions are also available to quickly seal a threaded port
- Instant connections to 4000 or 5000 psi eliminates tape, sealants and wrenches
- Swivel style allows easy installation while connected to a supply line
- No damage to threaded parts

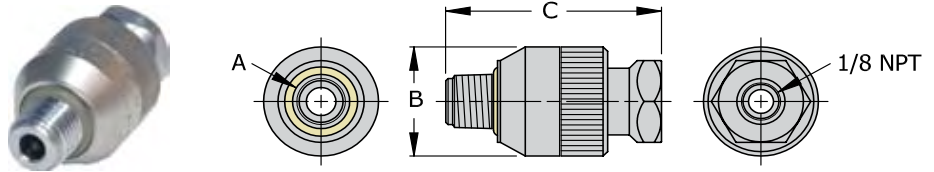

Swivel Style for NPT Threads

Part Number	Thread Size Dim "A"	Diameter Dim "B"	Length Dim "C"	Rating PSI	Housing Style	Housing Material	Seal Material	Main Seals Package (5)
MIT-022021	1/8" NPT	0.81"	1.69"	5000	Swivel	Stainless Steel	Urethane	S1109-U70
MIT-042021	1/4" NPT	1.00"	1.88"	5000				S1111-U70
MIT-062021	3/8" NPT	1.18"	2.09"	4000				S1113-U70
MIT-082021	1/2" NPT	1.36"	2.57"	4000				S1209-U70

Swivel Style for BSPP Threads

Part Number	Thread Size Dim "A"	Diameter Dim "B"	Length Dim "C"	Rating PSI	Housing Style	Housing Material	Seal Material	Main Seals Package (5)
MIT-026021	1/8" BSPP	0.81"	1.69"	5000	Swivel	Stainless Steel	Urethane	S1109-U70
MIT-046021	1/4" BSPP	1.00"	1.88"	5000				S1111-U70
MIT-066021	3/8" BSPP	1.18"	2.09"	4000				S1113-U70
MIT-086021	1/2" BSPP	1.36"	2.57"	4000				S1209-U70

Swivel Style for BSPT Threads

Part Number	Thread Size Dim "A"	Diameter Dim "B"	Length Dim "C"	Rating PSI	Housing Style	Housing Material	Seal Material	Main Seals Package (5)
MIT-026T021	1/8" BSPT	0.81"	1.69"	5000	Swivel	Stainless Steel	Urethane	S1109-U70
MIT-046T021	1/4" BSPT	1.00"	1.88"	5000				S1111-U70
MIT-066T021	3/8" BSPT	1.18"	2.09"	4000				S1113-U70
MIT-086T021	1/2" BSPT	1.36"	2.57"	4000				S1209-U70

Notes:

Optional seal materials available are FKM (Viton) and EPDM.

Examples: MIT-022021**V** = FKM
 MIT-022021**E** = EPDM

FasCal - "Twist to Connect" Connectors for Female Threads

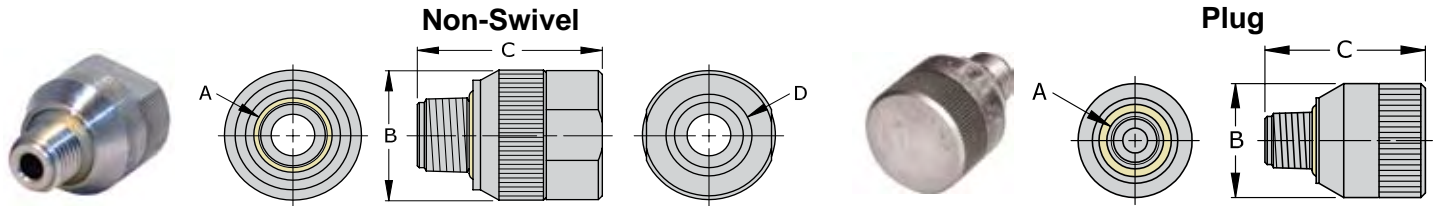

Non-Swivel Style for Female SAE O-Ring Boss

Part Number	Thread Size Dim "A"	Diameter Dim "B"	Length Dim "C"	Thread Size Dim "D"	Rating PSI	Housing Style	Housing Material	Seal Material	Main Seals Package (5)
MIT-044021X	-4 (7/16-20)	0.82"	1.29"	1/8" NPT	5000	Non Swivel	Stainless Steel	Urethane	S1109-U70
MIT-064041X	-6 (9/16-18)	1.00"	1.41"	1/4" NPT	5000				S1111-U70
MIT-084081X	-8 (3/4-16)	1.36"	1.85"	1/2" NPT	4000				S1209-U70
MIT-104081X	-10 (7/8-14)	1.36"	1.85"	1/2" NPT	4000				S1209-U70
MIT-124121X	-12 (1 1/16-12)	1.68"	1.94"	3/4" NPT	4000				S1213-U70
MIT-144161X	-14 (1 3/16-12)	2.00"	2.13"	1" NPT	4000				S1216-U70
MIT-164161X	-16 (1 5/16-12)	2.00"	2.13"	1" NPT	4000				S1217-U70

Plug Style for NPT Threads

Part Number	Thread Size Dim "A"	Diameter Dim "B"	Length Dim "C"	Rating PSI	Housing Style	Housing Material	Seal Material	Main Seals Package (5)
MIT-022P	1/8" NPT	0.81"	1.24"	5000	Plug	Stainless Steel	Urethane	S1109-U70
MIT-042P	1/4" NPT	1.00"	1.41"	5000				S1111-U70
MIT-062P	3/8" NPT	1.18"	1.49"	4000				S1113-U70
MIT-082P	1/2" NPT	1.36"	1.85"	4000				S1209-U70

Plug Style for BSPP Threads

Part Number	Thread Size Dim "A"	Diameter Dim "B"	Length Dim "C"	Rating PSI	Housing Style	Housing Material	Seal Material	Main Seals Package (5)
MIT-026P	1/8" BSPP	0.81"	1.24"	5000	Plug	Stainless Steel	Urethane	S1109-U70
MIT-046P	1/4" BSPP	1.00"	1.41"	5000				S1111-U70
MIT-062P	3/8" BSPP	1.18"	1.49"	4000				S1113-U70
MIT-082P	1/2" BSPP	1.36"	1.85"	4000				S1209-U70

Plug Style for BSPT Threads

Part Number	Thread Size Dim "A"	Diameter Dim "B"	Length Dim "C"	Rating PSI	Housing Style	Housing Material	Seal Material	Main Seals Package (5)
MIT-026TP	1/8" BSPT	0.81"	1.24"	5000	Plug	Stainless Steel	Urethane	S1109-U70
MIT-046TP	1/4" BSPT	1.00"	1.41"	5000				S1111-U70
MIT-062TP	3/8" BSPT	1.18"	1.49"	4000				S1113-U70
MIT-082TP	1/2" BSPT	1.36"	1.85"	4000				S1209-U70

Notes:

Optional seal materials available are FKM (Viton) and EPDM.

Examples: MIT-044021X**V** = FKM MIT-022P**V** = FKM
 MIT-044021X**E** = EPDM MIT-022P**E** = EPDM

FasCal - "Twist to Connect" Connectors for Male Threads



TwistMates unique "twist to connect" and pressure assisted grip and seal delivers fast, safe and repeatable threaded connections. Simply twist the connector to finger tight for an instant leak tight and high pressure connection.

- Compatible to NPT, BSPP, BSPT and SAE threads
- Instant connections to 4000 or 5000 psi eliminates tape, sealants and wrenches
- Internal swivel allows easy installation while connected to a supply line
- No damage to threaded parts

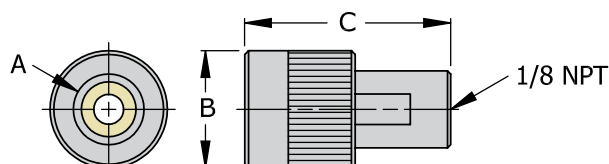

Swivel Style for NPT Threads

Part Number	Thread Size Dim "A"	Diameter Dim "B"	Length Dim "C"	Rating PSI	Housing Style	Housing Material	Seal Material	Main Seals Package (5)
MET-021021	1/8" NPT	0.80"	1.62"	5000	Swivel	Stainless Steel	Urethane	S1105-U70
MET-041021	1/4" NPT	0.93"	1.63"	5000				S1108-U70
MET-061021	3/8" NPT	1.20"	1.31"	4000				S1110-U70
MET-081021	1/2" NPT	1.36"	1.46"	4000				S1112-U70

Swivel Style for SAE 37° Flare - "AN" Type

Part Number	Thread Size Dim "A"	Diameter Dim "B"	Length Dim "C"	Rating PSI	Housing Style	Housing Material	Seal Material	Main Seals Package (5)
MET-049021	-4 (7/16-20)	0.80"	1.62"	5000	Swivel	Stainless Steel	Buna-N	S2070-0270B70
MET-069021	-6 (9/16-18)	0.93"	1.63"	5000				S1012-B70
MET-089021	-8 (3/4-16)	1.20"	1.31"	4000				S1015-B70

Swivel Style for BSPP Threads

Part Number	Thread Size Dim "A"	Diameter Dim "B"	Length Dim "C"	Rating PSI	Housing Style	Housing Material	Seal Material	Main Seals Package (5)
MET-025021	1/8" BSPP	0.80"	1.62"	5000	Swivel	Stainless Steel	Urethane	S1105-U70
MET-045021	1/4" BSPP	0.93"	1.63"	5000				S1108-U70
MET-065021	3/8" BSPP	1.20"	1.31"	4000				S1110-U70
MET-085021	1/2" BSPP	1.36"	1.46"	4000				S1112-U70

Swivel Style for BSPT Threads

Part Number	Thread Size Dim "A"	Diameter Dim "B"	Length Dim "C"	Rating PSI	Housing Style	Housing Material	Seal Material	Main Seals Package (5)
MET-025T021	1/8" BSPT	0.80"	1.62"	5000	Swivel	Stainless Steel	Urethane	S1105-U70
MET-045T021	1/4" BSPT	0.93"	1.63"	5000				S1108-U70
MET-065T021	3/8" BSPT	1.20"	1.31"	4000				S1110-U70
MET-085T021	1/2" BSPT	1.36"	1.46"	4000				S1112-U70

Notes:

Optional seal materials available are FKM (Viton) and EPDM.

Examples: MET-041021V = FKM MET-041021E = EPDM

FasCal - "Twist to Connect" Connectors for Male Threads



Swivel Style for MIL Spec 18997 Threads

Part Number	Thread Size	Rating PSI	Housing Style	Housing Material	Seal Material	Main Seals Package (5)
MET-06-18997-021	9/16-18 MIL Spec 18997	4000	Swivel	Stainless Steel	Urethane	S1109-U70

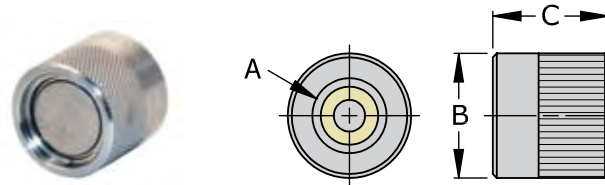

Cap Style for NPT Threads

Part Number	Thread Size Dim "A"	Diameter Dim "B"	Length Dim "C"	Rating PSI	Housing Style	Housing Material	Seal Material	Main Seals Package (5)
MET-021C	1/8" NPT	0.80"	0.83"	5000	Cap	Stainless Steel	Urethane	S1105-U70
MET-041C	1/4" NPT	0.93"	0.88"	5000				S1108-U70
MET-061C	3/8" NPT	1.20"	0.90"	4000				S1110-U70
MET-081C	1/2" NPT	1.36"	0.97"	4000				S1112-U70

Cap Style for BSPP Threads

Part Number	Thread Size Dim "A"	Diameter Dim "B"	Length Dim "C"	Rating PSI	Housing Style	Housing Material	Seal Material	Main Seals Package (5)
MET-025C	1/8" BSPP	0.80"	0.83"	5000	Cap	Stainless Steel	Urethane	S1105-U70
MET-045C	1/4" BSPP	0.93"	0.88"	5000				S1108-U70
MET-065C	3/8" BSPP	1.20"	0.90"	4000				S1110-U70
MET-085C	1/2" BSPP	1.36"	0.97"	4000				S1112-U70

Cap Style for BSPT Threads

Part Number	Thread Size Dim "A"	Diameter Dim "B"	Length Dim "C"	Rating PSI	Housing Style	Housing Material	Seal Material	Main Seals Package (5)
MET-025TC	1/8" BSPT	0.80"	0.83"	5000	Cap	Stainless Steel	Urethane	S1105-U70
MET-045TC	1/4" BSPT	0.93"	0.88"	5000				S1108-U70
MET-065TC	3/8" BSPT	1.20"	0.90"	4000				S1110-U70
MET-085TC	1/2" BSPT	1.36"	0.97"	4000				S1112-U70

Notes:

Optional seal materials available are FKM (Viton) and EPDM.

Examples: MET-021C**V** = FKM MET-021C**E** = EPDM

FasCal - "Twist to Connect" Connectors for Compression Fittings



TwistMates unique "twist to connect" and pressure assisted grip and seal delivers fast, safe and repeatable connections to *Swagelok*®, *Ferulok*® or similar style compression fittings. The connector's internal swivel allows easy installation while plumbed (connected) to a supply line. Simply twist the connector to finger tight for an instant leak tight and high pressure connection.

- Compatible to 1/4", 3/8" and 1/2" *Swagelok* and *Ferulok* style compression fittings
- Instant connections to 4000 or 5000 psi eliminates tape, sealants and wrenches
- No damage to threaded parts

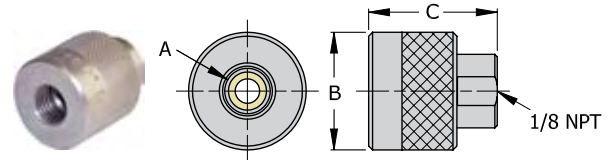

Double Ferrule Compression Fittings - Swivel Style for *Swagelok* and Similar Profiles

Part Number	Thread Size Dim "A"	Diameter Dim "B"	Length Dim "C"	Rating PSI	Housing Style	Housing Material	Seal Material	Main Seals Package (5)
MET-CF04021	1/4" (7/16-20)	0.95"	1.63"	5000	Swivel	Stainless Steel	Urethane	S1008-B70
MET-CF06021	3/8" (9/16-20)	1.20"	1.31"	4000				S1011-B70
MET-CF08021	1/2" (3/4-20)	1.38"	1.46"	4000				S1013-B70

Single Ferrule Compression Fittings - Swivel Swivel Style for *Ferulok* and Similar Profiles

Part Number	Thread Size Dim "A"	Diameter Dim "B"	Length Dim "C"	Rating PSI	Housing Style	Housing Material	Seal Material	Main Seals Package (5)
MET-CF04021F	1/4" (7/16-20)	0.95"	1.63"	5000	Swivel	Stainless Steel	Urethane	S1008-B70
MET-CF06021F	3/8" (9/16-18)	1.20"	1.31"	4000				S1011-B70
MET-CF08021F	1/2" (3/4-16)	1.38"	1.46"	4000				S1013-B70

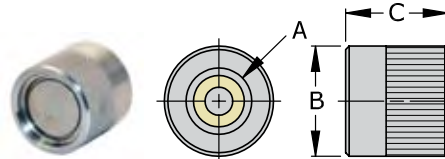

Double Ferrule Compression Fittings - Cap Style for *Swagelok* and Similar Profiles

Part Number	Thread Size Dim "A"	Diameter Dim "B"	Length Dim "C"	Rating PSI	Housing Style	Housing Material	Seal Material	Main Seals Package (5)
MET-CF04C	1/4" (7/16-20)	0.95"	0.88"	5000	Cap	Stainless Steel	Urethane	S1008-B70
MET-CF06C	3/8" (9/16-20)	1.20"	0.90"	4000				S1011-B70
MET-CF08C	1/2" (3/4-20)	1.38"	0.97"	4000				S1013-B70

Single Ferrule Compression Swivel Style Fittings - *Ferulok* and Similar Profiles

Part Number	Thread Size Dim "A"	Diameter Dim "B"	Length Dim "C"	Rating PSI	Housing Style	Housing Material	Seal Material	Main Seals Package (5)
MET-CF04CF	1/4" (7/16-20)	0.95"	0.88"	5000	Cap	Stainless Steel	Urethane	S1008-B70
MET-CF06CF	3/8" (9/16-18)	1.20"	0.90"	4000				S1011-B70
MET-CF08CF	1/2" (3/4-16)	1.38"	0.97"	4000				S1013-B70

Notes:

Optional seal materials available are FKM (Viton) and EPDM.

Examples: MET-CF04021**Y** = FKM MET-CF04021**E** = EPDM

Higher Pressure Connection Devices

CALIBRATE **5** **TIMES FASTER!**

- ✓ **Aerospace**
- ✓ **Military**
- ✓ **Naval**
- ✓ **Power Generation**
- ✓ **Industrial Applications**



FasCal - "Twist to Connect" TwistMate[®] Technology



Traditional methods of sealing require a combination of tape sealant, mating thread profiles and torque typically applied with wrenches. Each time a connection is taped and torqued to seal; wear or damage occurs to the mating threads.

TwistMates unique "twist to connect" and pressure assisted grip and seal delivers fast, safe and repeatable threaded connections. Simply twist the connector to finger tight for an instant leak tight and high pressure connection.

- Compatible to male and female NPT, 37° Flare/AN standard and SAE O-Ring threads
- Instant connections from vacuum to 10,000 psi eliminate tape, sealant and wrenches
- No damage to threaded parts
- Minimize contamination to process media

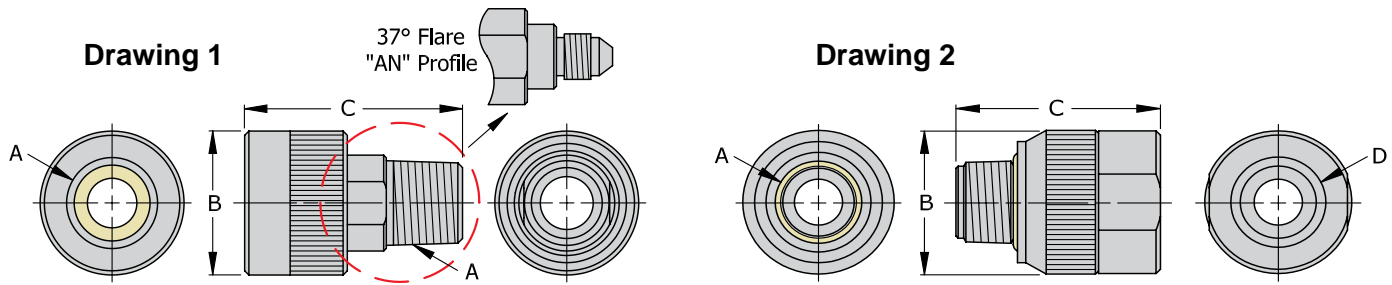

Higher Pressure Connectors for NPT Male Threads

	Part Number	Thread Size Dim "A"	Diameter Dim "B"	Length Dim "C"	Rating PSI	Housing Style	Housing Material	Seal Material	Main Seals Package (5)
Drawing 1	METH-021022	1/8" NPT	0.82"	1.51"	10,000	Swivel	Stainless Steel	Urethane	S1105-U70
	METH-041042	1/4" NPT	0.94"	1.74"	8000				S1108-U70
	METH-061062	3/8" NPT	1.18"	1.78"	8000				S1110-U70
	METH-081082	1/2" NPT	1.60"	2.05"	6000				S1112-U70
	METH-121122	3/4" NPT	1.68"	2.34"	5000				S1115-U70
	METH-161162	1" NPT	2.00"	2.74"	5000				S1212-U70

Higher Pressure Connectors for Male 37° Flare - AN Standard

	Part Number	Thread Size Dim "A"	Diameter Dim "B"	Length Dim "C"	Rating PSI	Housing Style	Housing Material	Seal Material	Main Seals Package (5)
Drawing 1	METH-049040	-4 (7/16-20)	0.95"	1.76"	10,000	Swivel	Stainless Steel	Buna N	S2070-0270B70
	METH-069060	-6 (9/16-18)	1.20"	1.83"	10,000				S1012-B70
	METH-089080	-8 (3/4-16)	1.38"	2.00"	10,000				S1015-B70
	METH-109100	-10 (7/8-14)	1.51"	2.35"	10,000				S1016-B70
	METH-129120	-12 (1 1/16-12)	1.70"	2.52"	10,000				S1018-B70

Higher Pressure Connectors for NPT Female Threads

	Part Number	Thread Size Dim "A"	Diameter Dim "B"	Length Dim "C"	Thread Size Dim "D"	Rating PSI	Housing Style	Housing Material	Seal Material	Main Seals Package (5)
Drawing 2	MITH-022021X	1/8" NPT	0.82"	1.24"	1/8" NPT	10,000	Non Swivel	Stainless Steel	Urethane	S1109-U70
	MITH-042041X	1/4" NPT	1.00"	1.41"	1/4" NPT	10,000				S1111-U70
	MITH-062061X	3/8" NPT	1.18"	1.48"	3/8" NPT	10,000				S1113-U70
	MITH-082081X	1/2" NPT	1.36"	1.85"	1/2" NPT	8000				S1209-U70
	MITH-122121X	3/4" NPT	1.68"	1.94"	3/4" NPT	7500				S1213-U70
	MITH-162161X	1" NPT	2.00"	2.07"	1" NPT	6500				S1216-U70

Higher Pressure Connectors for Female SAE O-Ring Boss

	Part Number	Thread Size Dim "A"	Diameter Dim "B"	Length Dim "C"	Thread Size Dim "D"	Rating PSI	Housing Style	Housing Material	Seal Material	Main Seals Package (5)
Drawing 2	MITH-044021X	-4 (7/16-20)	0.82"	1.29"	1/8" NPT	10,000	Non Swivel	Stainless Steel	Urethane	S1109-U70
	MITH-064041X	-6 (9/16-18)	1.00"	1.41"	1/4" NPT	10,000				S1111-U70
	MITH-084081X	-8 (3/4-16)	1.36"	1.85"	1/2" NPT	8000				S1209-U70
	MITH-104081X	-10 (7/8-14)	1.36"	1.85"	1/2" NPT	7500				S1209-U70
	MITH-124121X	-12 (1 1/16-12)	1.68"	1.94"	3/4" NPT	7500				S1213-U70
	MITH-144161X	-14 (1 3/16-12)	2.00"	2.13"	1" NPT	7000				S1216-U70
	MITH-164161X	-16 (1 5/16-12)	2.00"	2.13"	1" NPT	7000				S1217-U70

For Skydrol hydraulic fluid use, specify EPR seal material - "E".

Example: Connector - METH-049040E
Seal Set - 2070-0270E70

FasCal Accessories - Transition Connectors

TwistMates modular design is ideal for combining to transition from one thread profile to another to deliver the same features found with individual connectors. Save more time with assembled transition connectors from **Fastest** when instrument calibration time is critical.



- For 1/8" male to 1/8", 1/4", 3/8" and 1/2" female NPT, BSPP and BSPT threads
- Instant connections to 4000 or 5000 psi eliminates tape, sealants and wrenches
- Internal swivel allows easy installation while connected to a supply line

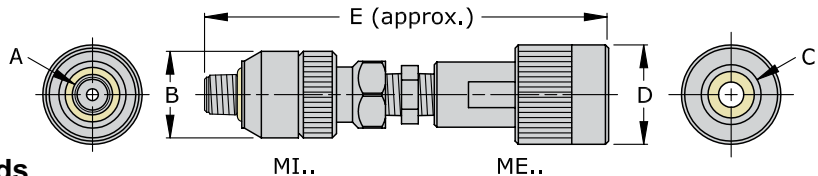

Transition Connectors for NPT Threads

Part Number	Thread Size Dim "A"	Dia. Dim "B"	Thd. Size Dim "C"	Dia. Dim "D"	Length Dim "E"	Rating PSI	Housing Style	Housing Material	Seal Material	MI .. Main Seals Package (5)	ME .. Main Seals Package (5)
MI022-ME021	1/8" NPT	0.81"	1/8" NPT	0.80"	3.74"	5000	Swivel	Stainless Steel	Urethane	S1109-U70	S1105-U70
MI022-ME041			1/4" NPT	0.93"	3.78"	5000					S1108-U70
MI022-ME061			3/8" NPT	1.20"	3.46"	4000					S1110-U70
MI022-ME081			1/2" NPT	1.36"	3.61"	4000					S1112-U70
MI042-ME021	1/4" NPT	1.00"	1/8" NPT	0.80"	3.95"	5000	Swivel	Stainless Steel	Urethane	S1111-U70	S1105-U70
MI042-ME041			1/4" NPT	0.93"	3.97"	5000					S1108-U70
MI042-ME061			3/8" NPT	1.20"	3.65"	4000					S1110-U70
MI042-ME081			1/2" NPT	1.36"	3.80"	4000					S1112-U70

Transition Connectors for BSPP Threads

Part Number	Thread Size Dim "A"	Dia. Dim "B"	Thd. Size Dim "C"	Dia. Dim "D"	Length Dim "E"	Rating PSI	Housing Style	Housing Material	Seal Material	MI .. Main Seals Package (5)	ME .. Main Seals Package (5)
MI026-ME025	1/8" BSPP	0.81"	1/8" BSPP	0.80"	3.74"	5000	Swivel	Stainless Steel	Urethane	S1109-U70	S1105-U70
MI026-ME045			1/4" BSPP	0.93"	3.78"	5000					S1108-U70
MI026-ME065			3/8" BSPP	1.20"	3.46"	4000					S1110-U70
MI026-ME085			1/2" BSPP	1.36"	3.61"	4000					S1112-U70
MI046-ME025	1/4" BSPP	1.00"	1/8" BSPP	0.80"	3.95"	5000	Swivel	Stainless Steel	Urethane	S1111-U70	S1105-U70
MI046-ME045			1/4" BSPP	0.93"	3.97"	5000					S1108-U70
MI046-ME065			3/8" BSPP	1.20"	3.65"	4000					S1110-U70
MI046-ME085			1/2" BSPP	1.36"	3.80"	4000					S1112-U70

Transition Connectors for BSPT Threads

Part Number	Thread Size Dim "A"	Dia. Dim "B"	Thd. Size Dim "C"	Dia. Dim "D"	Length Dim "E"	Rating PSI	Housing Style	Housing Material	Seal Material	MI .. Main Seals Package (5)	ME .. Main Seals Package (5)
MI026T-ME025T	1/8" BSPT	0.81"	1/8" BSPT	0.80"	3.74"	5000	Swivel	Stainless Steel	Urethane	S1109-U70	S1105-U70
MI026T-ME045T			1/4" BSPT	0.93"	3.78"	5000					S1108-U70
MI026T-ME065T			3/8" BSPT	1.20"	3.46"	4000					S1110-U70
MI026T-ME085T			1/2" BSPT	1.36"	3.61"	4000					S1112-U70
MI046T-ME025T	1/4" BSPT	1.00"	1/8" BSPT	0.80"	3.95"	5000	Swivel	Stainless Steel	Urethane	S1111-U70	S1105-U70
MI046T-ME045T			1/4" BSPT	0.93"	3.97"	5000					S1108-U70
MI046T-ME065T			3/8" BSPT	1.20"	3.65"	4000					S1110-U70
MI046T-ME085T			1/2" BSPT	1.36"	3.80"	4000					S1112-U70

FasCal Accessories - Adapter Fitting

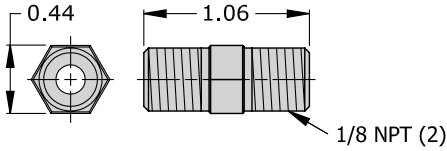

Build your own transition connectors. Make any combination by selecting two **FasCal** connection tools to join together with 1/8" male to 1/8" male adapter fitting. Additional options are hose assemblies featured on page 10.

Part Number	Thread Size	Rating PSI
APN022	1/8" NPT Male to 1/8" NPT Male	5000

FasCal Accessories - Hose Assemblies



FasTest high pressure hose assemblies are ideal for fast, modular connections in small hard to reach places where instrument calibration is necessary.

- 1/8" male to 1/8" male NPT threads mate to any **FasCal** connector
- Available in convenient 18, 36 and 72" lengths
- Pressure rated to 2500 psi

Part Number	Hose Length	Rating PSI	Hose Material	Connector Material
HP022X18	18 Inches	2500	SynFlex	Steel
HP022X36	36 Inches	2500	SynFlex	Steel
HP022X72	72 Inches	2500	SynFlex	Steel

Note: For assembled configurations with 1/8" NPT male connectors, consult factory.

FasCal - Basic Calibration Kits



The **FasCal** Basic Calibration Kit includes basic connectors needed to instantly improve your calibration throughput of transmitters, control valves and pressure sensing instruments and is ideal for every service vehicle in your fleet.

Basic Calibration Kit - FSC01

Part Number	Description	Specifications	Main Seals Package (5)
MIT-022021	1/8" Male NPT Swivel Connector	Page 7	S1109-U70
MIT-042021	1/4" Male NPT Swivel Connector		S1111-U70
MIT-082021	1/2" Male NPT Swivel Connector		S1209-U70
MIT-042021TM	1/4" Male NPT Swivel Connector for IEC Transmitter Ports	Page 6	S1111-U70
MET-021021	1/8" Female NPT Swivel Connector	Page 9	S1105-U70
MET-041021	1/4" Female NPT Swivel Connector		S1108-U70
MET-081021	1/2" Female NPT Swivel Connector		S1112-U70
FCC01	Plastic Tote Case		
STR012	Seal Service Tool		

FasCal - Basic Calibration Kits

Basic Calibration Kit - FSC01-BSPP

Part Number	Description	Specifications	Main Seals Package (5)
MIT-026021	1/8" Male BSPP Swivel Connector	Page 7	S1109-U70
MIT-046021	1/4" Male BSPP Swivel Connector		S1111-U70
MIT-086021	1/2" Male BSPP Swivel Connector		S1209-U70
MIT-042021TM	1/4" Male NPT Swivel Connector for IEC Transmitter Ports	Page 6	S1111-U70
MET-025021	1/8" Female BSPP Swivel Connector	Page 9	S1105-U70
MET-045021	1/4" Female BSPP Swivel Connector		S1108-U70
MET-085021	1/2" Female BSPP Swivel Connector		S1112-U70
FCC01	Plastic Tote Case		
STR012	Seal Service Tool		

Basic Calibration Kit - FSC01-BSPT

Part Number	Description	Specifications	Main Seals Package (5)
MIT-026T021	1/8" Male BSPT Swivel Connector	Page 7	S1109-U70
MIT-046T021	1/4" Male BSPT Swivel Connector		S1111-U70
MIT-086T021	1/2" Male BSPT Swivel Connector		S1209-U70
MIT-042021TM	1/4" Male NPT Swivel Connector for IEC Transmitter Ports	Page 6	S1111-U70
MET-025T021	1/8" Female BSPT Swivel Connector	Page 9	S1105-U70
MET-045T021	1/4" Female BSPT Swivel Connector		S1108-U70
MET-085T021	1/2" Female BSPT Swivel Connector		S1112-U70
FCC01	Plastic Tote Case		
STR012	Seal Service Tool		

FasCal - Master Lab Calibration Kits



The **FasCal** Master Lab Calibration Kit includes practically every connector needed for your calibration shop or service vehicle needs. The popular sleeve and lever actuated connectors combined with the “*twist to connect*” family of transition connectors are ideal for high volume efficient calibration of transmitters, gauges, control valves and pressure sensing instruments.

Master Lab Calibration Kit - FSC02

	Part Number	Description	Specifications	
Compression	HPB-CF04021	1/4" (7/16-20) Sleeve Actuated Connector for <i>Swagelok</i>	Page 4	
	MET-CF04021	1/4" (7/16-20) Connector for <i>Swagelok</i>	Page 11	
	MET-CF06021	3/8" (9/16-20) Connector for <i>Swagelok</i>		
	MET-CF08021	1/2" (3/4-20) Connector for <i>Swagelok</i>		
	MET-CF04C	1/4" (7/16-20) Cap for <i>Swagelok</i>		
	MET-CF06C	3/8" (9/16-20) Cap for <i>Swagelok</i>		
	MET-CF08C	1/2" (3/4-20) Cap for <i>Swagelok</i>		
IEC	L042021TM	1/4" Male NPT Lever Actuated Connector		Page 6
	MIT-042021TM	1/4" Male NPT Swivel Connector	Page 9	
Female Threads	MET-021021	1/8" Female NPT Swivel Connector		
	MET-041021	1/4" Female NPT Swivel Connector		
	MET-061021	3/8" Female NPT Swivel Connector		
	MET-081021	1/2" Female NPT Swivel Connector		
	MET-021C	1/8" Female NPT Cap		Page 10
	MET-041C	1/4" Female NPT Cap		
	MET-061C	3/8" Female NPT Cap		
MET-081C	1/2" Female NPT Cap			
Male Threads	MIT-022021	1/8" Male NPT Swivel Connector	Page 7	
	MIT-042021	1/4" Male NPT Swivel Connector		
	MIT-062021	3/8" Male NPT Swivel Connector		
	MIT-082021	1/2" Male NPT Swivel Connector		
	MIT-022P	1/8" Male NPT Plug	Page 8	
	MIT-042P	1/4" Male NPT Plug		
	MIT-062P	3/8" Male NPT Plug		
Male \ Female Adapters	MI022-ME021	1/8" Male NPT to 1/8" Female NPT Swivel Connector	Page 14	
	MI022-ME041	1/8" Male NPT to 1/4" Female NPT Swivel Connector		
	MI022-ME061	1/8" Male NPT to 3/8" Female NPT Swivel Connector		
	MI022-ME081	1/8" Male NPT to 1/2" Female NPT Swivel Connector		
	MI042-ME021	1/4" Male NPT to 1/8" Female NPT Swivel Connector		
	MI042-ME041	1/4" Male NPT to 1/4" Female NPT Swivel Connector		
	MI042-ME061	1/4" Male NPT to 3/8" Female NPT Swivel Connector		
	MI042-ME081	1/4" Male NPT to 1/2" Female NPT Swivel Connector		
APN022	1/8" Male NPT to 1/8" Male NPT Fitting			
Access.	HP022X036	1/8" Male NPT to 1/8" Male NPT 36" Hose Assembly	Page 15	
	FCC02	Plastic Cabinet Case		
	STR012	Seal Service Tool		

	Part Number
Replacement Seal Sets	S1008-B70
	S1011-B70
	S1013-B70
	S1105-U70
	S1108-U70
	S1109-U70
	S1110-U70
	S1111-U70
	S1112-U70
	S1113-U70
	S1209-U70
SL042B	

FasCal - Master Lab Calibration Kits

Master Lab Calibration Kit - FSC02-BSPP

	Part Number	Description	Specifications
Compression	HPB-CF04021	1/4" (7/16-20) Sleeve Actuated Connector for <i>Swagelok</i>	Page 4
	MET-CF04021	1/4" (7/16-20) Connector for <i>Swagelok</i>	Page 11
	MET-CF06021	3/8" (9/16-20) Connector for <i>Swagelok</i>	
	MET-CF08021	1/2" (3/4-20) Connector for <i>Swagelok</i>	
	MET-CF04C	1/4" (7/16-20) Cap for <i>Swagelok</i>	
	MET-CF06C	3/8" (9/16-20) Cap for <i>Swagelok</i>	
	MET-CF08C	1/2" (3/4-20) Cap for <i>Swagelok</i>	
	IEC	L042021TM	
MIT-042021TM		1/4" Male NPT Swivel Connector	
Female Threads	MET-025021	1/8" Female BSPP Swivel Connector	Page 9
	MET-045021	1/4" Female BSPP Swivel Connector	
	MET-065021	3/8" Female BSPP Swivel Connector	
	MET-085021	1/2" Female BSPP Swivel Connector	
	MET-025C	1/8" Female BSPP Cap	Page 10
	MET-045C	1/4" Female BSPP Cap	
	MET-065C	3/8" Female BSPP Cap	
	MET-085C	1/2" Female BSPP Cap	
Male Threads	MIT-026021	1/8" Male BSPP Swivel Connector	Page 7
	MIT-046021	1/4" Male BSPP Swivel Connector	
	MIT-066021	3/8" Male BSPP Swivel Connector	
	MIT-086021	1/2" Male BSPP Swivel Connector	
	MIT-026P	1/8" Male BSPP Plug	Page 8
	MIT-046P	1/4" Male BSPP Plug	
	MIT-066P	3/8" Male BSPP Plug	
Male \ Female Adapters	MI026-ME025	1/8" Male BSPP to 1/8" Female BSPP Swivel Connector	Page 14
	MI026-ME045	1/8" Male BSPP to 1/4" Female BSPP Swivel Connector	
	MI026-ME065	1/8" Male BSPP to 3/8" Female BSPP Swivel Connector	
	MI026-ME085	1/8" Male BSPP to 1/2" Female BSPP Swivel Connector	
	MI046-ME025	1/4" Male BSPP to 1/8" Female BSPP Swivel Connector	
	MI046-ME045	1/4" Male BSPP to 1/4" Female BSPP Swivel Connector	
	MI046-ME065	1/4" Male BSPP to 3/8" Female BSPP Swivel Connector	
	MI046-ME085	1/4" Male BSPP to 1/2" Female BSPP Swivel Connector	
Access.	APN022	1/8" Male NPT to 1/8" Male NPT Fitting	Page 15
	HP022X036	1/8" Male NPT to 1/8" Male NPT 36" Hose Assembly	
	FCC02	Plastic Cabinet Case	
	STR012	Seal Service Tool	

	Part Number
Replacement Seal Sets	S1008-B70
	S1011-B70
	S1013-B70
	S1105-U70
	S1108-U70
	S1109-U70
	S1110-U70
	S1111-U70
	S1112-U70
	S1113-U70
	S1209-U70
	SL042B

FasCal - Master Lab Calibration Kits

Master Lab Calibration Kit - FSC02-BSPT

	Part Number	Description	Specifications
Compression	HPB-CF04021	1/4" (7/16-20) Sleeve Actuated Connector for <i>Swagelok</i>	Page 4
	MET-CF04021	1/4" (7/16-20) Connector for <i>Swagelok</i>	Page 11
	MET-CF06021	3/8" (9/16-20) Connector for <i>Swagelok</i>	
	MET-CF08021	1/2" (3/4-20) Connector for <i>Swagelok</i>	
	MET-CF04C	1/4" (7/16-20) Cap for <i>Swagelok</i>	
	MET-CF06C	3/8" (9/16-20) Cap for <i>Swagelok</i>	
	MET-CF08C	1/2" (3/4-20) Cap for <i>Swagelok</i>	
	IEC	L042021TM	
MIT-042021TM		1/4" Male NPT Swivel Connector	
Female Threads	MET-025T021	1/8" Female BSPT Swivel Connector	Page 9
	MET-045T021	1/4" Female BSPT Swivel Connector	
	MET-065T021	3/8" Female BSPT Swivel Connector	
	MET-085T021	1/2" Female BSPT Swivel Connector	
	MET-025TC	1/8" Female BSPT Cap	Page 10
	MET-045TC	1/4" Female BSPT Cap	
	MET-065TC	3/8" Female BSPT Cap	
	MET-085TC	1/2" Female BSPT Cap	
Male Threads	MIT-026T021	1/8" Male BSPT Swivel Connector	Page 7
	MIT-046T021	1/4" Male BSPT Swivel Connector	
	MIT-066T021	3/8" Male BSPT Swivel Connector	
	MIT-086T021	1/2" Male BSPT Swivel Connector	
	MIT-026TP	1/8" Male BSPT Plug	Page 8
	MIT-046TP	1/4" Male BSPT Plug	
	MIT-066TP	3/8" Male BSPT Plug	
	MIT-086TP	1/2" Male BSPT Plug	
Male \ Female Adapters	MI026T-ME025T	1/8" Male BSPT to 1/8" Female BSPT Swivel Connector	Page 14
	MI026T-ME045T	1/8" Male BSPT to 1/4" Female BSPT Swivel Connector	
	MI026T-ME065T	1/8" Male BSPT to 3/8" Female BSPT Swivel Connector	
	MI026T-ME085T	1/8" Male BSPT to 1/2" Female BSPT Swivel Connector	
	MI046T-ME025T	1/4" Male BSPT to 1/8" Female BSPT Swivel Connector	
	MI046T-ME045T	1/4" Male BSPT to 1/4" Female BSPT Swivel Connector	
	MI046T-ME065T	1/4" Male BSPT to 3/8" Female BSPT Swivel Connector	
	MI046T-ME085T	1/4" Male BSPT to 1/2" Female BSPT Swivel Connector	
Access.	APN022	1/8" Male NPT to 1/8" Male NPT Fitting	Page 15
	HP022X036	1/8" Male NPT to 1/8" Male NPT 36" Hose Assembly	
	FCC02	Plastic Cabinet Case	
	STR012	Seal Service Tool	

	Part Number
Replacement Seal Sets	S1008-B70
	S1011-B70
	S1013-B70
	S1105-U70
	S1108-U70
	S1109-U70
	S1110-U70
	S1111-U70
	S1112-U70
	S1113-U70
	S1209-U70
	SL042B

Additional Products and Brochures from FasTest



Engineering & Application Guide

Engineering and Application Guide to Connectors for Pressure Testing & Processing details our complete offering for all applications.



Medical Connectors

Versatile product line of connectors for sealing and testing a wide variety of medical products and drug delivery devices.



Refrigeration Connectors

The **CoreMax** system of high flow processing valves and connectors for the refrigeration manufacturing and service industry.

Additional Options and Services from FasTest

ReConnect - Our connector refurbishment and competitor replacement program ensures proper connector operation and performance and extends the service life and warranty of your investment. Connectors routinely maintained can be refurbished or replaced economically relative the cost of a new connector replacement. Visit www.fastestinc.com/reconnect or contact **FasTest** for details.

ReConnect

Custom Applications - Customized products are available for unusual or unique connection requirements.

Limited Express Warranty

FasTest Inc. warrants its products against defects in workmanship and materials for 12 months from the date of sale by FasTest Inc. or its authorized distributor. This warranty is void if the product is misused, tampered with or used in a manner that is contrary to FasTest Inc.'s written recommendations and/or instructions.

FasTest Inc. does not warrant the suitability of the product for any particular application. Determining product application suitability is solely the customer's responsibility. FasTest Inc. is not liable for consequential or other damages including, but not limited to, loss, damage, personal injury, or any other expense directly or indirectly arising from the use of or inability to use its products either separately or in combination with other products.

ALL OTHER WARRANTIES EXPRESS OR IMPLIED, WHETHER ORAL, WRITTEN OR IN ANY OTHER FORM, INCLUDING BUT NOT LIMITED TO WARRANTIES OF MERCHANTABILITY OR FITNESS FOR A PARTICULAR PURPOSE ARE EXPRESSLY EXCLUDED.

The sole and exclusive remedy under this warranty is limited to replacement of the product or an account credit in the amount of the original selling price, at the option of FasTest Inc. All allegedly defective products must be returned prepaid transportation to FasTest Inc., together with information describing the product's performance, unless disposition in the field is authorized in writing by FasTest Inc.

Notifications and Copyright

Specifications in this brochure are subject to change without notice. FasTest also reserves the right to make modifications and makes no guarantee of the accuracy of the information contained herein.

© 2010 FasTest Inc. All rights reserved. No part of this publication may be reproduced with written without permission.